

161 Series CARBURETOR PARTS PLATE
(Models 161-7, 161X7, 161J7, 161JX7, 161XX7)

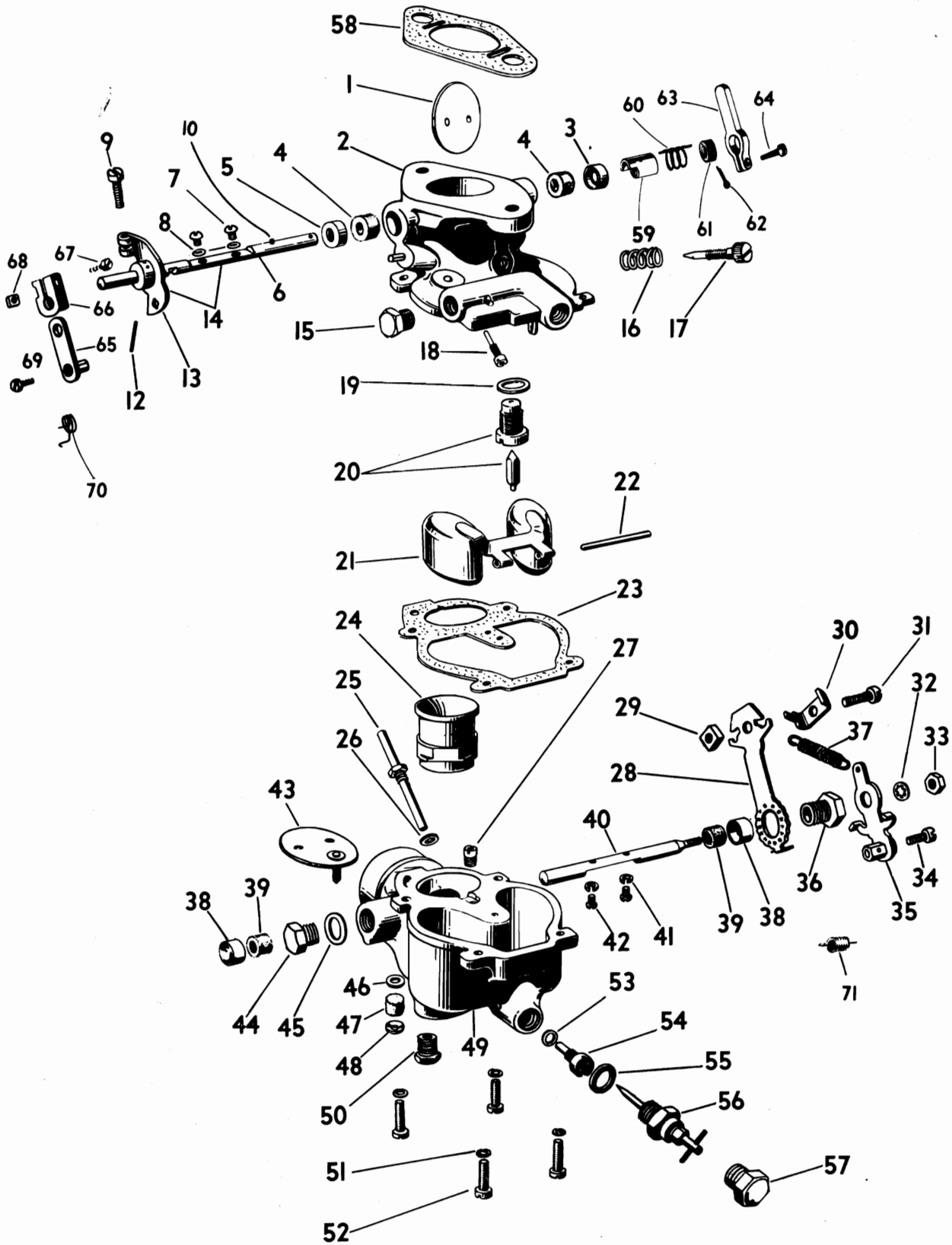

161 Series CARBURETOR PARTS LIST
(Models 161-7, 161X7, 161J7, 161JX7, 161XX7)

Ref. No.	Part No.	Part Name	Ref. No.	Part No.	Part Name
1	C21-88	Plate—throttle	40		*Shaft—choke
2	B2-	*Body—throttle	41	T41-5	Lockwasher—plate screw
3	CR37-1X1	Plug—throttle shaft hole	42	T15B5-3	Screw—choke plate
4	CT57-4	Washer—throttle shaft packing	43	C101-17	Plate—choke
5	C131-4X2	Retainer—packing	43	C101-60	Plate—choke (special light valve spring)
7	T15B5-3	Screw—throttle plate	44	C138-24	Plug—choke shaft hole
8	T41-5	Lockwasher—plate screw		CR37-1X2	Plug—choke shaft hole (cup type)
9	T1S8-10	Screw—lever stop		CR137-19	Plug—choke shaft hole (solid type)
10	C121-12	Pin—throttle shaft	45	T56-23	Washer—choke shaft hole plug
14	C29-	*Shaft and Lever—throttle	46	CT52-7	Washer—intake drain
15	CT91-3	Plug—fuel inlet	47	CT57-12	Washer—drain felt
	C150-17	Elbow and Screen—fuel (I.H.C.)	48	CT93S-51	Retainer—felt washer
16	C111-9	Spring—idle adjusting needle	49	B3-	*Bowl—fuel
16	C111-17	Spring—idle adjusting needle (for C46-6 needle)	50	CT91-3	Plug—bowl drain
				T150-1	Valve—bowl drain
17	C46-25	Needle—idle adjusting	51	T41-10	Lockwasher—bowl to body screw
17	C46-6	Needle—idle adjusting (No 12-32thd. I. H. C.)	52	T1S10-10	Screw—bowl to body
			53	T56-24	Washer—main jet
18	C55-6-2	*Jet—idle	54	C52-6-30	*Jet—main
19	T56-20	Washer—fuel valve seat	55	T56-23	Washer—main passage plug
20	C81-17-	*Valve and Seat—fuel	56	C71-21	Adjustment—main jet
21	C85-	*Float	57	C138-23	Plug—main passage
22	C120-4	Axle—float (brass)	58	C141-4-5	Gasket—flange (161-7)
22	C120-42	Axle—float (stainless steel)	58	C141-4-6	Gasket—flange (161X7)
23	C142-16	Gasket—bowl to body	59	CR26-61	Bushing—throttle lever (brass)
24	C38-	*Venturi	59	C26-81	Bushing—throttle lever (steel)
25	C66-50-40	*Jet—discharge	60	C117-27	Spring—throttle lever (R. H. coil)
26	T56-52	Washer—discharge jet	61	CR115-10	Retainer—spring
27	C77-18-15	*Vent—well	62	T61-4	Cotter pin
28	C109-	*Bracket—choke	63	C24-	*Lever—throttle clamp
29	T21S8	Nut—clamp screw	64	T8S10-9	Screw—lever clamp
30	C110-1	Clamp—bracket tube	65	C25-18X2	Lever—floating
31	T1S8-10	Screw—tube clamp	66	C25-98AX2	Stop—floating lever
32	T45-8	Lockwasher—shaft nut (No. 8)	67	T1S10-12	Screw—stop clamp
32	T41-10	Lockwasher—shaft nut (No. 10)	68	T24S10	Nut—clamp screw
33	T22S8	Nut—choke shaft (No. 8-36 thd.)	69	T8S8-7	Screw—swivel
33	T22S10	Nut—choke shaft (No. 10-32 thd.)	70	C117-6	Spring—floating lever (R. H.)
34	T1S8-6	Screw—swivel	70	C117-8	Spring—floating lever (L. H.)
35		*Lever—choke	71	C117-13	Spring—choke lever (L. H. 6 coils)
36	C140-2	Screw—bracket assembly		C117-18	Spring—choke lever (L. H. 5½ coils)
36	C140-7	Screw—bracket assembly (packed)		C117-36	Spring—choke lever (R. H. 5½ coils)
37	C112-6	Spring—choke lever		CR9-13	Bushing—throttle shaft
38	C131-4X2	Retainer—packing		C181-66	Gasket set
39	CT57-4	Washer—shaft packing		K501	Basic repair kit

* Refer to the SPECIFICATION BULLETIN

for complete part number including size of calibrated parts.